

Building the Frame

Please begin by assembling the frame parts. Please familiarise yourself with the different frame parts. The final page of this manual features a parts list.

The circular frame of the JumpPOD comprises 8 curved top tubes. There are 2 different types of Top Tube: **Key No. 2** (detailed below) and **Key No. 1** (detailed overleaf).

The Top Tubes must be assembled in the correct order for the frame to be secure.

14ft JumpPOD Classic. Please start with the following parts:

1 x Enclosure 'A' Socket (Key No. 4) and 1 x Top Tube (Key No. 2).

Large 'A' Socket



With the top tube in this position you should see **5 spring holes**, as shown below.

Slim square end



Top Tube (Key No. 2)

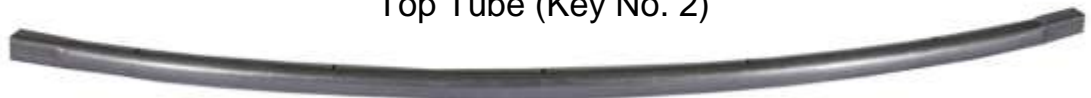

Please use the following information to identify the correct parts.

The curved Top Tube (Key No. 2) above has two square ends. One square end is **slimmer** than the other. Please ensure that you have 5 spring holes visible as shown, with the **slimmer** square end on the **right**. (6 spring holes will be face down on the ground). **This is essential for the assembly.**

The larger square end should be on the left. Push the Large 'A' Socket (Key No. 4) on to the larger square end, as shown above.

Important!

Make sure the small screw hole on the Large 'A' Socket is positioned on the outside of the curve, as shown.



Important!

Make sure that the spring hole in the square end of Top Tube (Key No. 2) aligns with the opening in the Large 'A' Socket (Key No. 4).



Repeat this with the 3 remaining Key No. 2 and 4.

14ft JumpPOD Classic. Please then take the following parts:

1 x 'B' Socket (Key No. 3) with 1 x Top Tube (Key No. 1).

Small 'B' Socket

With the top tube in this position you should see **6 spring holes**, as shown below.

Square end



The curved top tube above will have the Small 'B' Socket already attached, as shown above.

Detached 'B' Sockets? The following information will assist you if your 'B' Sockets are detached. If the 'B' Socket has come off, please assemble Key No. 2 and Key No. 4 **first**, as shown on the previous page.

Then position Top Tube (Key No. 1) as shown above, with **6 spring holes visible**, and 5 spring holes **face down** on the ground. You will see that the top tube has two square ends.

Push the Small 'B' Socket onto the square end on the left, as shown above.

Please ensure that the left hand square end is pushed **all the way through** the Small 'B' Socket, so it is flush with the edge of the Small 'B' Socket, as shown below.

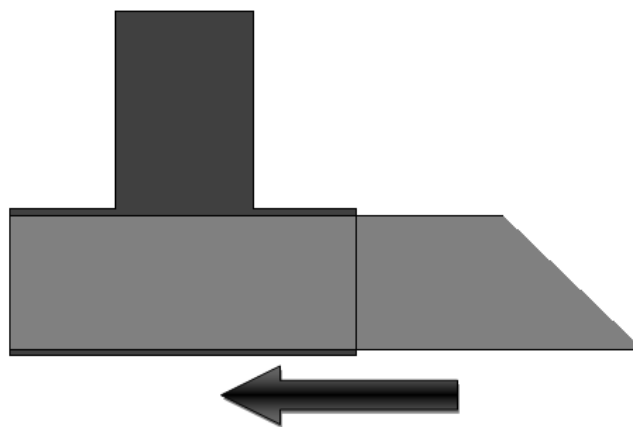

Repeat this with the 3 remaining Key No. 1 and 3.

Note: For the rest of the guide, Key No.'s will be detailed in brackets after the part description, for example 'Top Tube (1)'.

Make sure you wear gloves.

Be careful where you place your hands as frame joints can pinch.

The easiest way to put the trampoline together is in 4 individual quadrants.

For the first of these 4 quadrants, please lay out the Top Tubes (2) and (1) as shown below.

Make sure the 'A' and 'B' Sockets are securely attached, as shown in the previous steps.

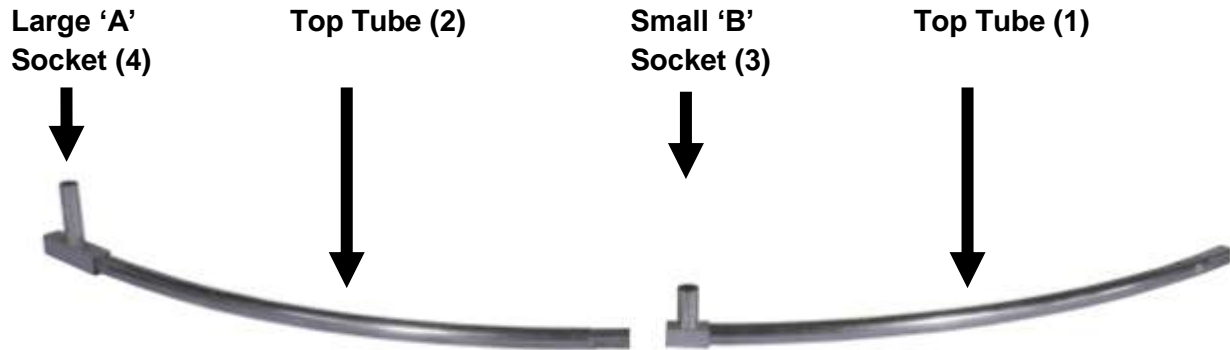

Insert the **slim** square end of one Top Tube (2) into the Top Tube (1), joining the tubes as shown below.

This will create a male and female connection **inside** the Small 'B' Socket (3), as shown on the right.

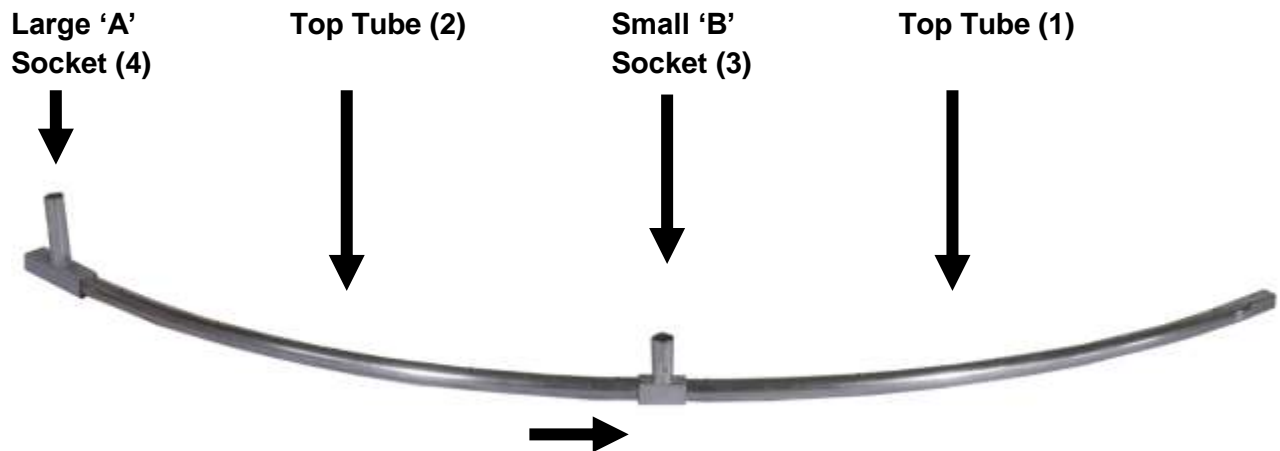
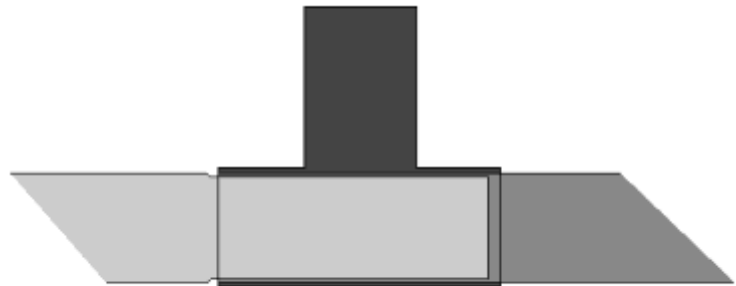

Now take 1 x Leg Extension 'A' (6) and insert it into the Large 'A' Socket (4) of the left hand Top Tube (2).



Take the Centre Leg (7) and insert this into the Leg Extension 'A' (6), as shown.



Then take a Leg Extension 'B' (5), and attach it to the **Centre Leg** (7) as shown.



Make sure you wear gloves.

Now grasp the free end of Leg Extension 'B' (5) and pull until it lines up with the open Small 'B' Socket (3).

By placing your hands further down the Leg Extension 'B' (5), you can increase your leverage.



You can also place your feet on the top rails either side of the Small 'B' Socket (3) to steady the assembly, as shown in the image.

Pull the Leg Extension 'B' (5) into the open Small 'B' Socket (3). Once you have inserted the Leg Extension 'B' (5), push down firmly on the Centre Leg (7) to ensure a tight fit.



You have now completed 1 x quadrant, as shown.



Repeat these steps to assemble 3 more quadrants, giving 4 in total.



This next step will require at least 2 people. Make sure you are wearing gloves.

Turn the 4 x quadrants over and join 2 sections to together as shown.



The spring holes in the end of the Top Tubes will line up with the openings in the top face of the Large 'A' Socket (4). If this does not happen please check the layout of your Top Tubes, as shown in the first steps.



Push the end of Top Tube (2) into the open end of Large 'A' Socket (4)



Then add a third quadrant, as shown.



Make sure you wear gloves, as frame joints can pinch.

Now add the fourth quadrant to form the circular shape.

This will require extra effort. The easiest method is for 2 people to face each other.

Then hold the Top Tubes either side of the sockets and both push towards the centre of the trampoline.

As the 2 people push towards each other, 1 person can join the final part of the circle.



You will now have a completed Frame, as shown below.



Attaching the Bed and the Surround Pad

Please wear gloves and protective eyewear for the following steps.

Take the Stitched Bed with V-Rings (8) and lay it on the ground inside the trampoline frame. Make sure the 2 warning labels are on the **top** of the bed.



Note: There are V-Rings around the edge of the Bed (8), and holes around the **top and underside** of the Top Tubes (1 and 2).

During this step, you will attach the Bed (8) to the frame using the included Spring Pulling Tool (20).



There are 8 x V-Rings with **yellow stitching** on the Bed (8), as shown.

Please locate the V-Rings with yellow stitching.

These will be 90 degrees from each other, with 2 each at 12 'o clock, 3 'o clock, 6 'o clock and 9 'o clock.

Rotate the bed so the V-Rings with **yellow stitching** line up with the 4 x Large 'A' Sockets (4).



Make sure you wear gloves.

Be careful where you place your hands; the springs and frame joints can pinch.

Start with a Yellow Spring (11).

To attach a spring, first hook the more tightly curled end of the Yellow spring (11) onto a **V-Ring with yellow stitching**, as shown.

Then use the spring tool (20) to connect the Yellow Spring to the Large 'A' Socket (4).



Repeat this, connecting a second Yellow Spring (11) to the Large 'A' Socket (4).



The **V-Rings with yellow stitching** correspond with the 4 x Large 'A' Sockets (4).

Now attach 2 more **V-Rings with yellow stitching** at the **opposite** side (at 180 degrees / 6 'o clock) of the Bed (8).

Again, attach the 2 Yellow springs (11) to the Large 'A' Socket (4).

The Bed (8) will now be attached at opposite points (12 'o clock and 6 'o clock), as shown.



Then attach the remaining 4 **V-Rings with yellow stitching** to the trampoline frame using Yellow Springs (11), at 3 'o clock and 9 'o clock).

Again, attach these Yellow springs (11) to the Large 'A' Socket (4).

The Bed (8) will now be attached at 4 equally spaced points.

This sequence evenly spreads the tension, making it easier to attach the springs.



Now attach 8 silver Springs (10), so the Bed (8) is attached at 8 equal points.

These points will be **either side** of the Small 'B' Socket (3), and may be under springs.

Please remember to count the spring holes on the top **and** the underside to the Top Tubes (1 and 2) when fitting the bed.



Then attach the remaining upper Springs (10), followed by the lower springs.

Warning: Do not use the trampoline until the surround pad and the safety enclosure have also been fitted.



Now take the Frame Pad (9) and spread it out on the trampoline.



Rotate the Frame Pad (9) so the holes align with the Large 'A' Sockets (4) as shown.

Do not fasten the Surround Pad to the Frame at this stage, as this will be done later.



The Frame Pad is designed to reduce the likelihood of injury to the user, caused from coming in contact with the trampoline frame or springs. If you do not have a Frame Pad please contact your vendor / supplier immediately.

Building the Safety Enclosure

You will now assemble the Safety Enclosure for your trampoline.

Take the Enclosure Top Tube (13) and Enclosure Straight Pole (12). You may find that the Foam Sleeves (16) are already fitted.

Find the tapered end of the Enclosure Straight Tube (12) and insert it into the Enclosure Top Tube (13), as shown.



Rotate the Enclosure Top Tube (13) and Enclosure Straight Tube (12) so the screw holes align.

Then screw the Tubes together using a self tapping screw (17). **The screw will require extra effort for the initial few rotations.**

Repeat this with the remaining 3 x Enclosure Top Tubes (13) and Enclosure Straight Tubes (12), so you have 4 identical Enclosure Tube assemblies.



Take one of the completed Enclosure Poles and carefully lay it flat on the trampoline bed, with the end of the Enclosure Straight Pole (12) towards the Large 'A' Socket (4) at the edge of the frame.

Then lift the edge of the Frame Pad (9).

Carefully push the Enclosure Straight Pole (12) through the opening in the Frame Pad (9), as shown.

Then insert the end of the Enclosure Straight Pole (12) into the opening of the Large 'A' Socket (4).



Then secure the Enclosure Pole in the Large 'A' Socket (4) with a self tapping screw. **The screw will require extra effort for the initial few rotations.**



Repeat this step to attach all 4 x Enclosure poles as shown, securing each one with a self tapping screw.



Now take the Netting (18) and spread it across the diameter of the trampoline as shown.

There is a stitched sleeve at the top of the Net (18). Open the Velcro flaps that cover the sleeve openings.

Make sure this sleeve is spread out flat across the Bed (8). This will make assembly easier.



Then take the black G3 Pole sections (14). You will see these poles are connected with an internal elastic cord, as shown.

Please unfold and join the G3 Pole (14) to make a long pole.

Then repeat this with the remaining G3 Pole (14), so you have 2 x separate long black poles.



Take one of the completed long G3 Poles (14) to the Net (18).

Then locate the channel inside the stitched sleeve at the top of the Net (18).

Insert and push one of the long G3 Poles (14) into the stitched sleeve as shown.

This process will be much easier if the Net (18) is flat across the trampoline.



Make sure the long G3 Pole (14) passes through the semi-circular openings and then goes back into the channel at the top of the Net (18).



The G3 Pole (14) will become visible at the opposite end of the Net (18).

Then repeat this process with the second G3 Pole (14) in the parallel stitched sleeve at the top of the Net (18).

Make sure that you have a connecting sleeve on one of the black G3 Pole sections, as shown.



Now join the 2 x G3 Poles (14) at the top of the Net (18) together, using the connecting sleeves (at one end of the G3 Poles).

This requires two people. Please ensure you wear gloves.

Stand opposite each other and grasp the two ends of the G3 Poles (14) as shown. Then slowly push towards each other, making the G3 Poles arch (14). This will make it easier to join the 2 x G3 Poles (14).



Connect the 2 x G3 Poles (14) using the connecting sleeve as shown.

When the Poles are connected please close the Velcro flaps of the channel at the top of the net.

The Net (18) will now be a round shape.

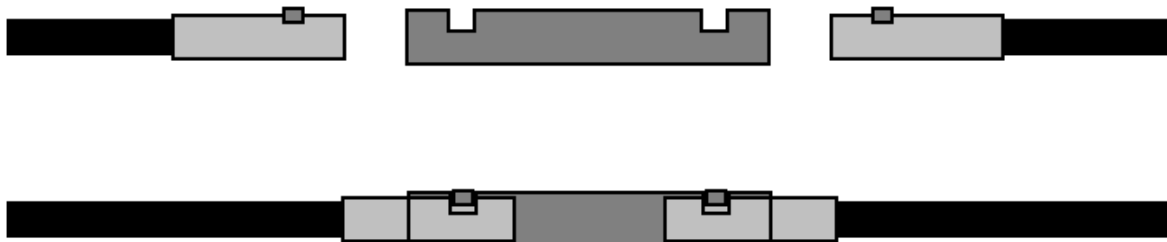

The next step is to hang the Net (14) on the 4 x Enclosure Top Tubes (13).

Locate the 4 x exposed areas of the G3 Pole (14) at the top of the Net (18), as shown.

Rotate the Net (18) so the exposed G3 Poles (14) line up with the Enclosure Tube assemblies.

Important: The Net (18) hangs inside the 4 x Enclosure Poles. Please do not stretch the Net (18) over the Enclosure Poles.



Then stand on the trampoline bed, and insert the exposed sections of the G3 Pole (14) into one of the Plastic Caps (22) on top of the Enclosure Top Tube (13) as shown.

Please note that cap colour and shape may vary.

Now turn around and approach the Enclosure Top Tube (13) that is **directly opposite** the first hanging point. Attach the G3 Pole (14) here in the same way, followed by the remaining 2 x Enclosure Top Tubes (13).



You will now 'sew' the bottom edge of the Net (18) to the V-Rings of the Bed (8).

Take the pack of Cords (21) and select a single cord.



Starting underneath the entrance to the net, take the single Cord (21) and push the red needle end down through the bottom of the Net (18).

This image shows inside of the net. You may find it easier to perform this step whilst on the Bed (8), inside the Net.

Please ensure you can exit via the zipped Net entrance before attempting this step.



Continue and push the red cord needle (21) through the nearest V-Ring of the Bed (8), and then back towards you.

Keep the Net (18) and the Cord (21) taut as you sew. Repeat this process, making sure the net is sewn to every V-Ring.

When you come to the end of the Cord (21), tie it to a V-Ring with a double knot and begin with another Cord (21). Continue this process until you reach your starting point.



The Next step is to secure the Frame Pad (9) to the Trampoline Frame.

There are a series of straps and metal D-rings around the edge of the Frame Pad (9).

Secure the outer straps to the Top Tubes (1 and 2) as shown.



You will now finish securing the Frame Pad (9).

Look under the trampoline. There is a series of elasticated straps around the inside edge of the Frame Pad (9).

Tie these straps by hand around the nearest Spring (10) or V-Ring.



Now attach the Safety Placard (19) to the frame using a plastic tie, near the point where jumpers will climb onto and off the trampoline.

The trampoline is now fully assembled. Make sure that all parts are securely attached.



Familiarize yourself and all users of the trampoline with the safety precautions, use and instructional materials, and care and maintenance instructions in this manual before using the trampolines.

To disassemble the trampoline and enclosure, please follow assembly steps in reverse order.

Do not attempt to disassemble any trampoline frame components before the springs and the bed have been removed. Use gloves to protect your hands from pinch points during disassembly.